



Anti-Bacterial Deodorizer

MXAP-ARD100

PA1096-00

Instruction Manual

Thank you for purchasing this MAXELL product.
Read this Instruction Manual in order to use the product correctly and read the “Safety Precautions” before use.
Carefully keep this Manual after reading in an easy to access location.

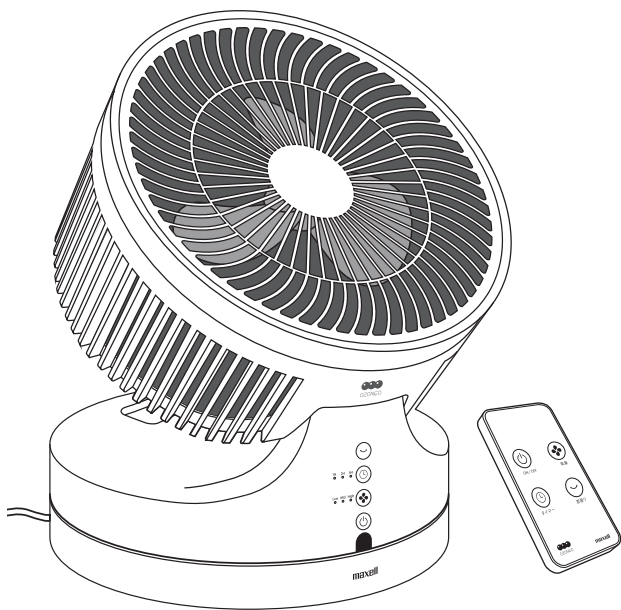

Table of contents	Page
1 Introduction	1
2 Safety precautions	1 ~ 5
3 Name of each part	6
4 About the remote controller	7
5 How to use	8 ~ 10
6 Maintenance and storage	11 ~ 12
7 Troubleshooting	13
8 Specifications	13 ~ 14
9 About main body labeling indications based on long-term use product safety indication system	14

This product is for use in Japan only.

1 Introduction

■ Keep the following in mind when reading the Instruction Manual.

- This Instruction Manual may be subject to change without prior notice.
- In order to improve the product, external appearance or part of the specifications may be subject to change without prior notice.
- Unauthorized duplication of part or all of this Instruction Manual without permission is prohibited except for the case of personal use. In addition, do not reprint this Instruction Manual without permission.

■ Disclaimer (See the warranty certificate for details of the warranty.)

- We assume no responsibility for any damage caused by fire, earthquake, action by any third party, other accidents, customer's intention or fault, incorrect use, or use under other abnormal conditions.
- We assume no responsibility for any damage caused by malfunction due to combination with connection equipment and devices.
- This product is not intended for use with equipment and devices related to human life such as medical equipment and devices, nuclear equipment and devices, aerospace equipment and devices, transportation equipment, and equipment and devices which require a high standard of reliability. We assume no responsibility if this product is used for the control systems of these types of equipment and devices and if any injury or fire occurs due to failure of the product.

■ Influence of ozone on human body

Influence of ozone on human body

Ozone concentration (ppm)	Influence
0.01	Person who has a sensitive sense of smell senses ozone odor.
0.02	Senses ozone odor (acclimates after a while).
0.06	Environmental baseline concentration of photochemical oxidant (Ministry of the Environment)
0.1	Senses strong ozone odor. Irritation to nose and throat.
	Acceptable concentration in working environment (Japan Society for Occupational Health)

※With reference to the ozone handbook of the Japan Ozone Association

※Ozone concentration of the product is designed to be 0.06ppm or less.

2 Safety precautions

Make sure to observe the following in order to use the product safely.





⚠ WARNING Indicates the degree of danger in which incorrect handling may result in death or serious injury*1 to a user.

⚠ CAUTION Indicates the degree of danger or the state of damage in which incorrect handling may result in slight injury*2 to a user or damage to property*3.

*1: Serious injury means injury with aftereffects such as loss of sight, burns, electric shock, bone fracture or poisoning and injury which requires hospitalization or long-term hospital visits for medical treatment.

*2: Slight injury means injury, burns, or electric shock which does not require hospitalization or long-term hospital visits for medical treatment.

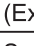
*3: Damage to property means consequential damage related to house, household goods and livestock or pets.

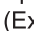
Examples of pictorial indication		Symbol  prohibits an action in handling of the product. Specific prohibited content is shown in or near the pictorial symbol by picture or words. (Example:  Do Not Disassemble)
		Symbol  forces a user to perform an action based on the instruction in handling of the product. Specific content is forced as shown in or near the pictorial symbol by picture or words. (Example:  Disconnect a plug from the outlet.)

⚠ WARNING

- Do not use the product in a place where a ventilation system is not available.
- Do not use the product in a narrow space such as a washroom where any person is present.
Use of the product in an improper environment may result in a hazard to the human body or pets, and damage to property.
- When using or storing the product, keep it out of the reach of children.
Otherwise, electric shock or injury may occur.
- When using the product in an environment where a small animal may live, pay special attention to the condition of the small animal.
- Note that items that rust easily and natural rubber will easily deteriorate if they are exposed to ozone.
- When concerned about an ozone-specific odor or feeling any change in physical condition such as a headache during use, stop using of the product and ventilate the room. Also, consult a doctor.
- A person having an existing medical condition such as asthma should consult a doctor before use.

⚠ WARNING

■ Abnormal condition and failure

- **Stop use of the product immediately when an abnormal condition or failure occurs and disconnect the power plug from the outlet.**

When smoke, abnormal odor or noise emits from the product, or when water or a foreign substance has entered inside the product, immediately stop use of the product and disconnect the power plug.

Use of the product as it is may result in smoking, heat generation, ignition or electric shock.



- **Stop use of the product immediately at the time of dropping or breaking.**

Use of the product as it is may result in heat generation, ignition, electric shock or injury.



■ Installation and use

- **Do not use the product in a place where a ventilation system is not available.**
- **Do not use the product in a narrow space such as a washroom where any person is present.**
Use of the product in an improper environment may result in a hazard to the human body or pets, and damage to property.
- **Use the product only with AC100V.**
Otherwise, ignition or heat generation may occur.
- **Do not use the product in a place where there is any flame, oily smoke, inflammable gas or metallic dust.**
Otherwise, ignition or heat generation may occur.
- **Do not direct the fan to combustion appliances when using the product.**
Otherwise, fire by scattering flames or an incomplete combustion may occur.



- **Do not use the product in a humid place.**

Do not use the product in a bathroom, on a beach, on a waterfront or outdoors.

In addition, pay special attention to use in a room where a humidifier operates excessively.

Otherwise, electric shock or ignition may occur.



- **Do not use the product in a place where water may be splashed over the product.**

Otherwise, electric shock or ignition may occur.



-
- **When you hear the sound of thunder, do not touch the main body, power plug or power cord.**
Otherwise, electric shock may occur.



Don Not Touch

-
- **When using or storing the product, keep it out of the reach of children and animals.**
Otherwise, electric shock or injury may occur.

- **When storing the packaging bag, keep it out of the reach of children.**
If a child accidentally pulls the bag over his/her head or wraps the bag around his/her neck, he/she may choke and die.



■ Main body and remote controller

-
- **Do not repair, alter or disassemble the main body or the remote controller.**
Otherwise, heat generation, ignition, electric shock or failure may occur.



-
- **Keep the main body and the remote controller dry.**
Do not wet the main body or the remote controller with water or pour water on them. Otherwise, heat generation, electric shock or failure may occur.



Keep Dry

-
- **Do not put the main body or the remote controller into a fire.**
Do not throw the main body or the remote controller into a fire or heat them. Otherwise, heat generation or ignition may occur.



-
- **Do not use the main body or the remote controller with wet hands.**
Otherwise, electric shock or failure may occur.



■ Main body

-
- **Do not operate the product without fan blades and guards.**
Otherwise, injury or failure may occur.
 - **Do not use a loosened outlet.**
Do not use an outlet which is loosened when the power plug is inserted. Otherwise, electric shock, short circuit or ignition may occur.
 - **Do not use a damaged power cord or power plug.**
Otherwise, electric shock, short circuit or ignition may occur.
 - **Do not damage, bend forcibly, twist, bind, pinch or process the power cord or put a heavy object on it.**
Otherwise, fire or electric shock may occur.



-
- **Make sure to insert the power plug completely.**
Use of the product with the power plug inserted incompletely may result in electric shock or fire.



-
- **Do not insert your finger or a rod into the guard, movable part or gap.**
Otherwise, injury may occur.
 - **Do not insert any foreign substance such as a pin, wire or metallic object into an opening or gap.**
Otherwise, electric shock or injury may occur.
 - **Do not put a cloth or cover on the main body when using the product.**
Otherwise, heat generation or ignition may occur.



■ Battery

- **When storing a battery, keep it out of the reach of children.**

If a child swallows a battery, immediately seek medical attention from a doctor.

- **Handle batteries with extreme care.**

Improper use may cause heat generation or rupture, resulting in injury, burn or electric shock.

- Do not use a battery other than that specified (Specified battery: CR2032)
- Do not use a battery with “+” and “-” reversed.
- Do not place a battery within reach of children.
- Do not charge, disassemble, short-circuit or heat a battery or put it into a fire.
- Do not use any battery which is deformed or flawed or to which a foreign substance is attached.



■ Maintenance

- **Make sure to disconnect the power plug before maintenance and cleaning the product.**

Otherwise, electric shock or ignition may occur.



Disconnect the
Power Plug

- **Periodically remove dust on the power plug.**

Periodically remove dirt and dust.

Otherwise, humidity may cause an insulation defect, resulting in a fire.

- **Make sure to disconnect the power plug if the product will not be used for a long time.**

Otherwise, insulation deterioration may result in electric shock or fire from a short circuit.



⚠ CAUTION

■ Installation and use

- **Do not use the product around obstacles (such as curtains) or in an unstable location.**

Curtains may be sucked into the guard, resulting in breakage or failure.

If the product is placed on an uneven stand or on an inclined surface, it may drop or tilt, resulting in injury or failure.

- **Do not place the product in a humid or dusty place.**

Do not place the product in a bathroom, near a humidifier or cooking counter or in a dusty place.

Otherwise, heat generation, ignition or electric shock may occur.

- **Do not place the product near a TV set or radio.**

Otherwise, image distortion or noise may occur.

- **Do not place the product in direct sunlight or in a place with abnormally high temperatures.**

Otherwise, the surface of the device and parts may deteriorate, and additionally, heat generation or ignition may occur.

Do not place the product near a heating appliance such as a stove.

- **Do not expose your body to wind generated by the product.**

Otherwise, you may feel ill or your health may be harmed.

- **Do not bring your face close to the guard.**

Your hair may be caught in the fan blades, resulting in injury.

- **Do not turn on the product when condensation occurs on the product.**

A rapid change in environmental temperature may result in condensation inside the product.

When condensation occurs, leave the product for a while with the power off.



■ Main body

- **Do not sit on or ride on the main body.**
Otherwise, injury, breakage or failure may occur.
- **Do not hold the guard by hand to stop the swinging motion.**
Otherwise, injury or failure may occur.
- **Do not move the main body during operation.**
Otherwise, injury or failure may occur.



-
- **Stop using of the product when the main body abnormally vibrates.**
Otherwise, fan blades or guards may dropped out resulting in injury.
 - **When disconnecting the power plug, do not hold the power cord but make sure to securely hold the power plug to remove.**
Otherwise, electric shock, short circuit or ignition may occur.



■ Maintenance

- **Do not use chemicals.**
When wiping the main body, do not use benzine, thinner or alcohol, etc.
In addition, do not use an electrical contact cleaner. Otherwise, the exterior may be damaged and parts may dissolve.



3 Name of each part

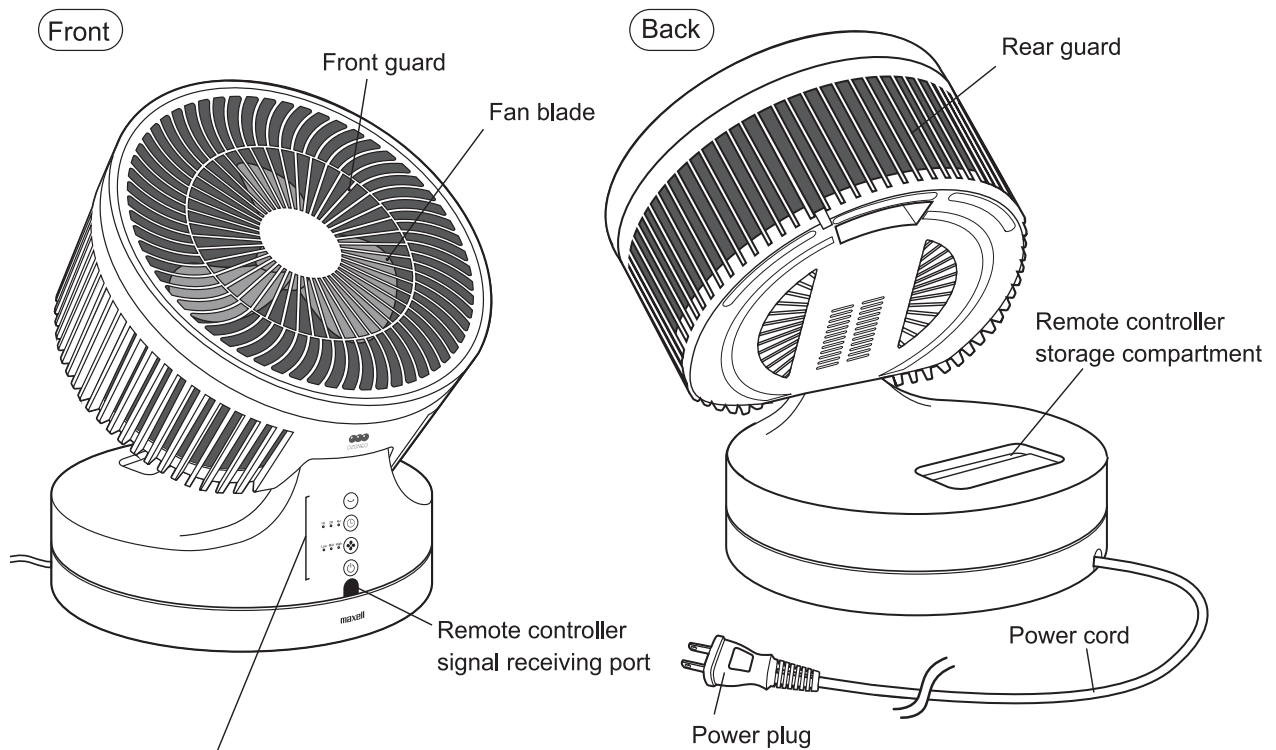

Operating part

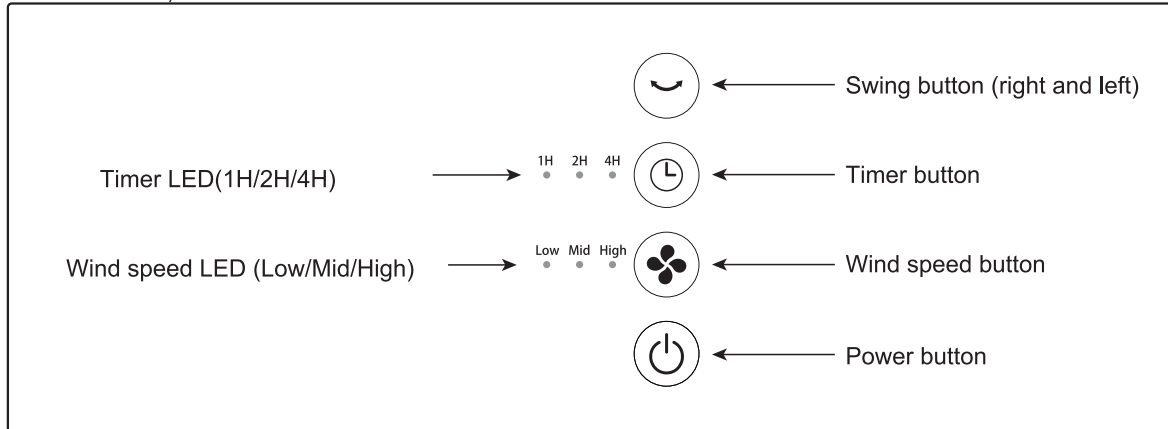

Included accessories

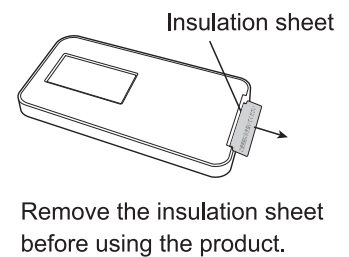
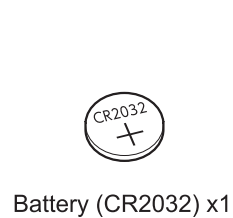
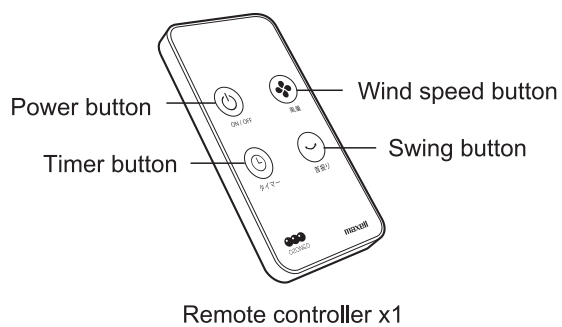

4 About the remote controller

■ How to insert a battery

- (1) Turn over the remote controller and press the lock on the battery holder in the direction of the arrow (1).
- (2) Pull out the battery holder in the state of (1).
- (3) Put a battery into the battery holder with the + side of the battery facing upward.
(※ The included battery may use up earlier in comparison with a new battery because it is a sample item.)
- (4) Insert the battery holder until a “click” sound is heard.

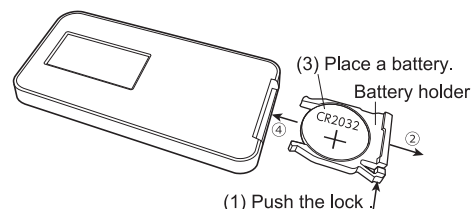

Note

- If a battery is incorrectly used, the product may be corroded by liquid leaking from the battery or the battery may rupture.
- Use only the specified battery (CR2032).
- Check the direction of the “+” and “-” and correctly insert a battery.
- Do not charge, short-circuit, disassemble or heat a battery.
- When remote controller operation becomes unavailable, replace the battery with a new battery.
- Dispose used batteries according to the waste separation method specified in your community.
- When the product is not used for a long time, remove the battery and store separately.

■ How to operate

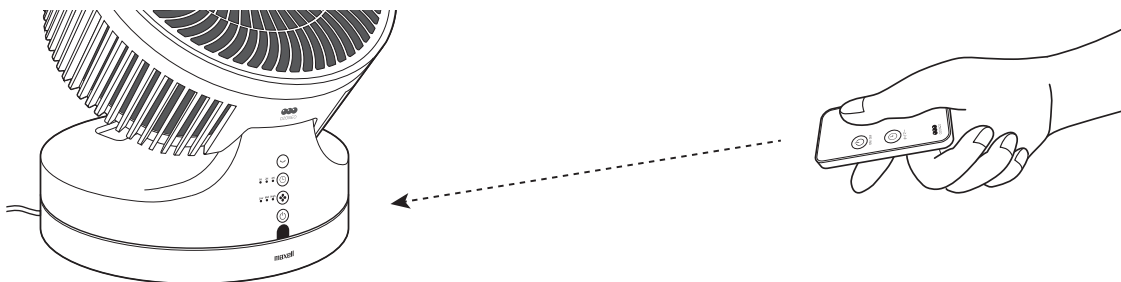

Direct the remote controller to the signal receiving port of the main body and operate the product.

The remote controller can be used within a range of 3m from the main body.

※ The product may not have response if the remote controller is directed toward any direction other than the signal receiving port

Note

- Do not press two or more buttons simultaneously.
- Do not drop, step on or give a strong impact to the remote controller.
- The remote controller cannot be operated in the following places where:
There is an obstacle between the signal receiving port on the main body and the remote controller.
The signal receiving port on the main body is exposed to intense light such as direct sunlight.
Inverter type lighting equipment is used.

[4]

5 How to use

⚠ WARNING

- Make sure to insert the power plug fully into an outlet of AC100V.
- Do not insert your finger or a rod into the guard, movable part or gap.
- Do not use the product in a place where a ventilation system is not available.
- Do not use the product in a narrow space such as a washroom where any person is present.

■ Installation

- Install the main body at a distance of approx. 50cm from laundry.
- Insert the power plug into the outlet.

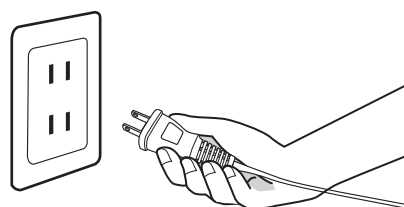
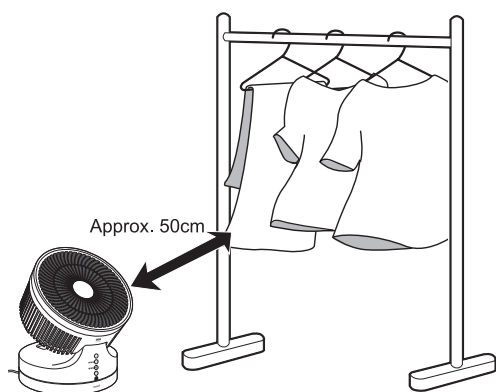

■ Operation

- Press the power button. Start operation in the Mid wind speed mode with the timer set to 1H.
- When the power button is pressed during operation, the power turns off and the operation stops.

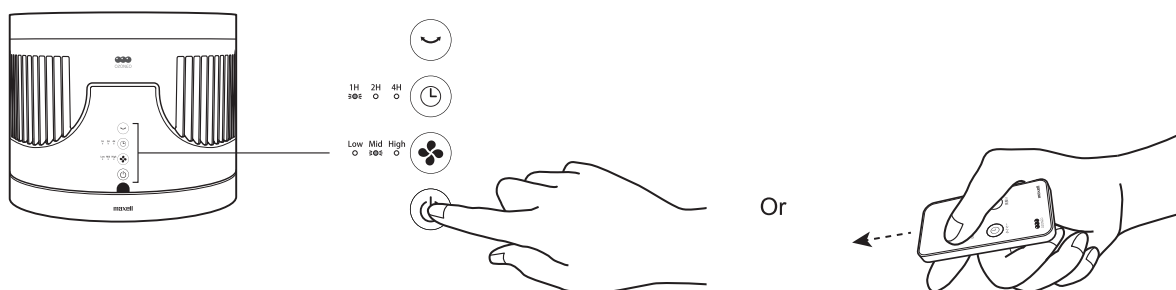

■ Adjust wind speed

- The wind speed will change when the wind speed button is pressed.
Mid wind speed is the default setting.
- When press the wind speed button, the wind speed will change as the following sequence.
(Mid → High → Low → Mid)

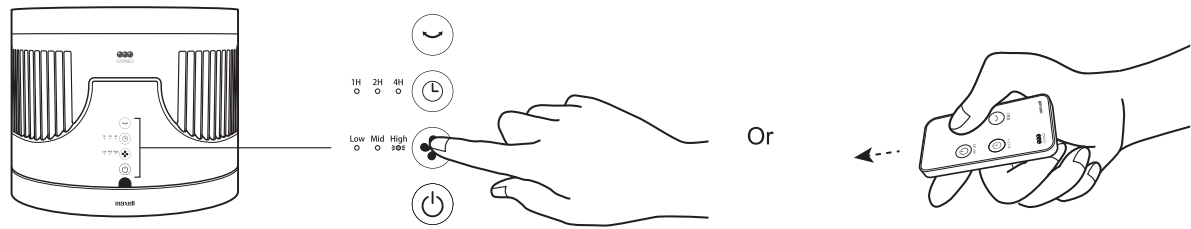

■ Set the timer

- When the timer button is pressed, the off timer set time changes.

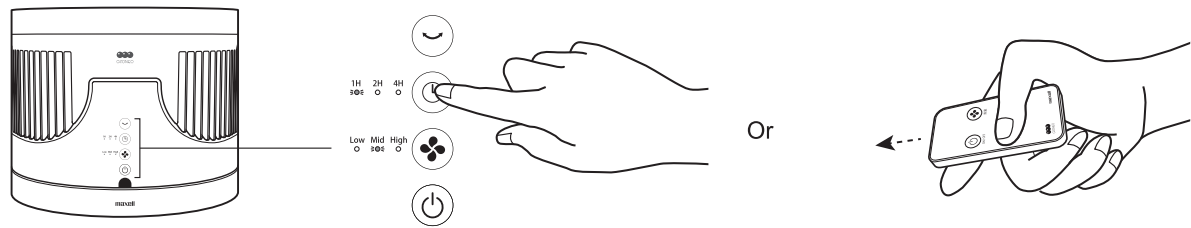

1 hour			2 hours			3 hours			4 hours			5 hours			6 hours			7 hours		
1H	2H	4H	1H	2H	4H	1H	2H	4H	1H	2H	4H	1H	2H	4H	1H	2H	4H	1H	2H	4H
≡●≡	○	○	○	≡●≡	○	≡●≡	≡●≡	○	○	○	≡●≡	≡●≡	○	≡●≡	○	≡●≡	≡●≡	≡●≡	≡●≡	≡●≡

1H is set when operation is started.
Set a desired time and use the product.
※Even when the timer is not set, the Auto OFF function works and operation is stopped in 8 hours.
(When the timer is not set, the timer LED goes off.)

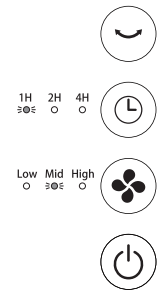

■ Change the wind direction (upward/downward)

- The wind direction can be manually changed upward or downward.
The angle can be changed in three stages (0 degree, 45 degrees, 90 degrees).

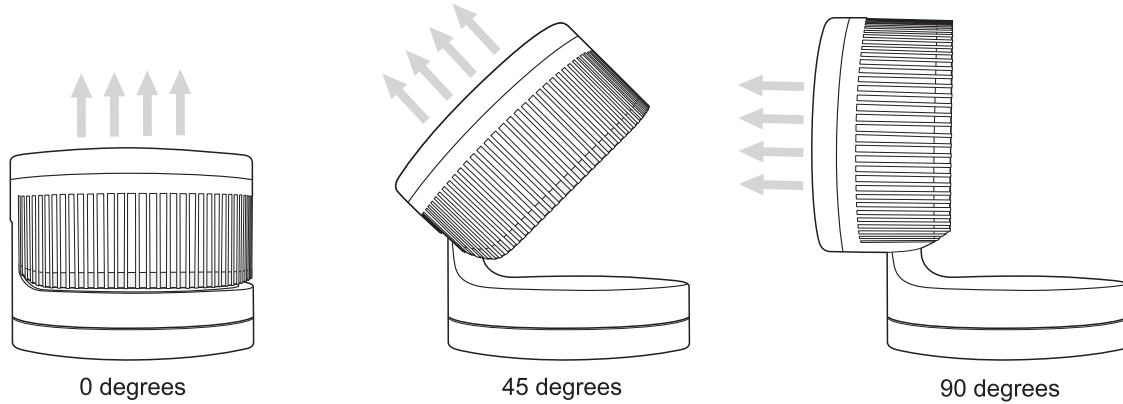

Note

- Change the wind direction upward or downward while operation is stopped.

■ Set side-to-side swinging motion

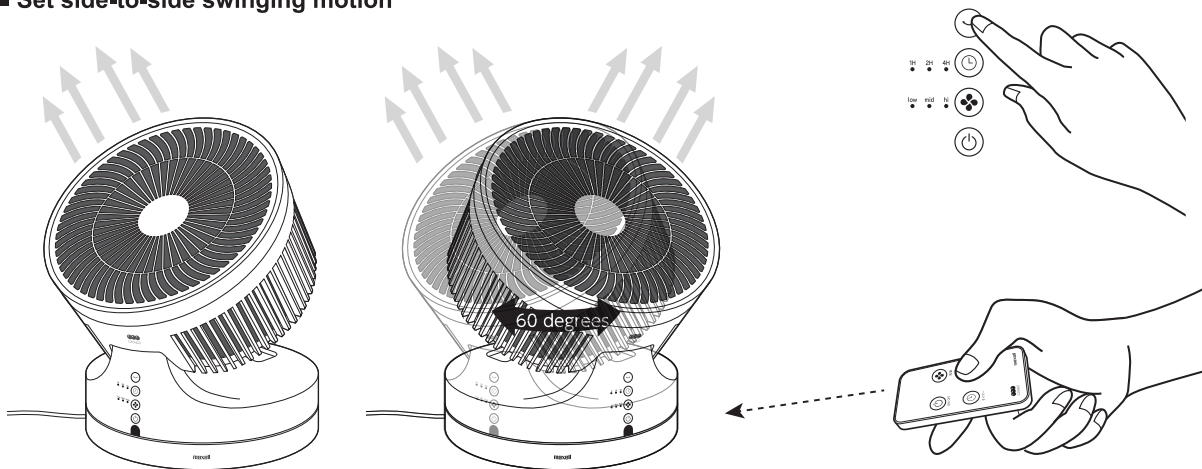

- When the swing button is pressed, side-to-side swinging motion is started in a range of approx. 60 degrees .
- When the swing button is pressed again during swinging motion, swinging motion is stopped.

Note

- Make sure confirm that there is no obstacle around the product before starting swinging motion.
- Do not disrupt swinging motion by holding the guard during swinging motion.
- Sounds are produced during swinging motion (sounds from the motor and the gear), however, this is not abnormal.

6 Maintenance and storage

Note

- Be careful not to pinch or injure your fingers when removing or installing parts.
- Securely install the front guard and fan blades. If the front guard or fan blades are not securely installed, it may cause an injury.
- Do not remove the "Finger Insertion Caution seal" attached to the fan blade.

■ Before maintenance

Make sure to stop operation and disconnect the power plug from the outlet before maintenance of the product.

■ How to remove the front guard and fan blades

- (1) Remove the guard fixing screw on the upper part of the rear guard with a cross slot screwdriver.

※ Use a screwdriver long enough to reach the screw.

- (2) Set the angle to 0 degree.

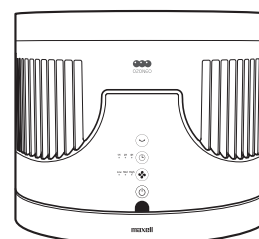
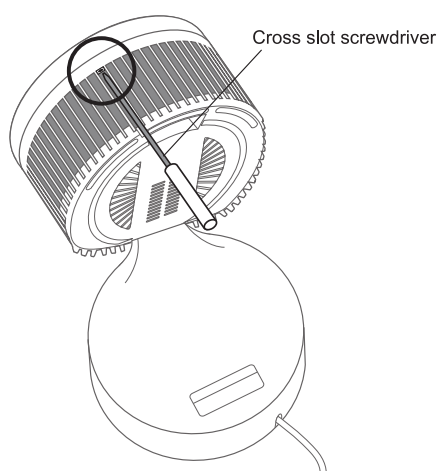
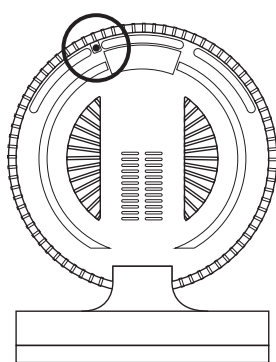

- (3) Turn the front guard in the direction of the arrow, and align the inverted triangle mark with the  mark and remove the guard.

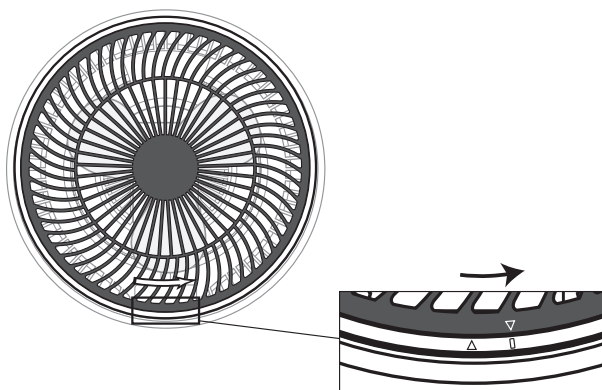

- (4) Turn the spinner clockwise to remove it. And then, remove the fan blades.

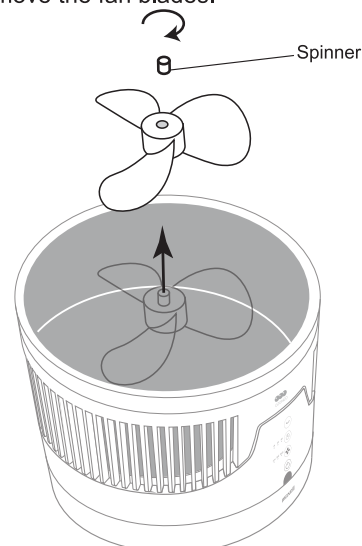

■ How to maintain for the main body and fan blades

Remove contamination using a cloth moistened with neutral detergent and water, and wipe with a soft dry cloth.
Do not use benzine, thinner or alcohol, etc.

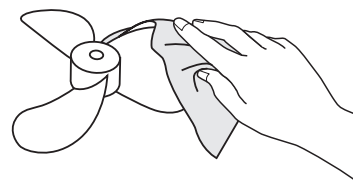

■ How to maintain for the ozone unit

- (1) Remove the screw hole cover and 3 screws on the ozone unit to open.
- (2) Lightly wipe a part indicated by the arrow on the ozone unit with a cotton swab.

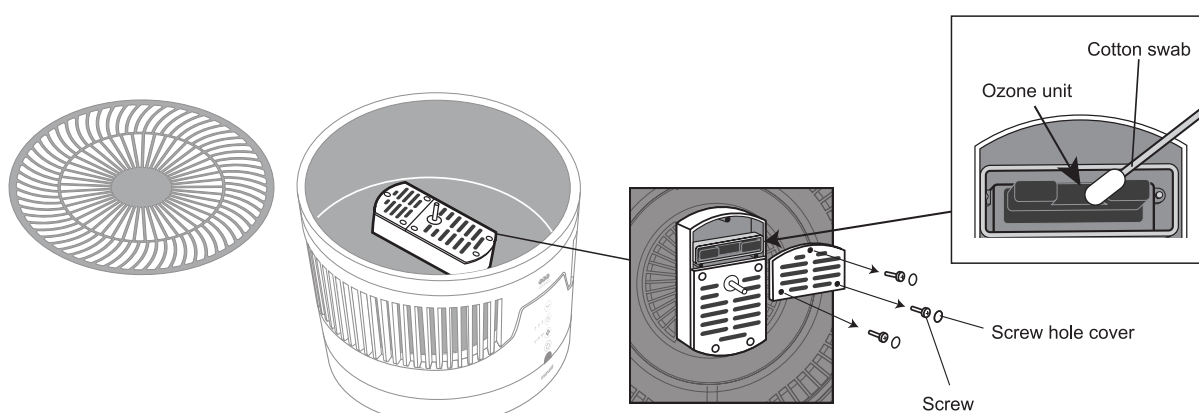

■ How to install the front guard and fan blades

- (1) Install the fan blades and turn the spinner counterclockwise to tighten it.
- (2) Install the front guard and turn it to align the inverted triangle mark with the \triangle mark.
- (3) Tighten the guard fixing screw on the upper part of the rear guard with a cross slot screwdriver.

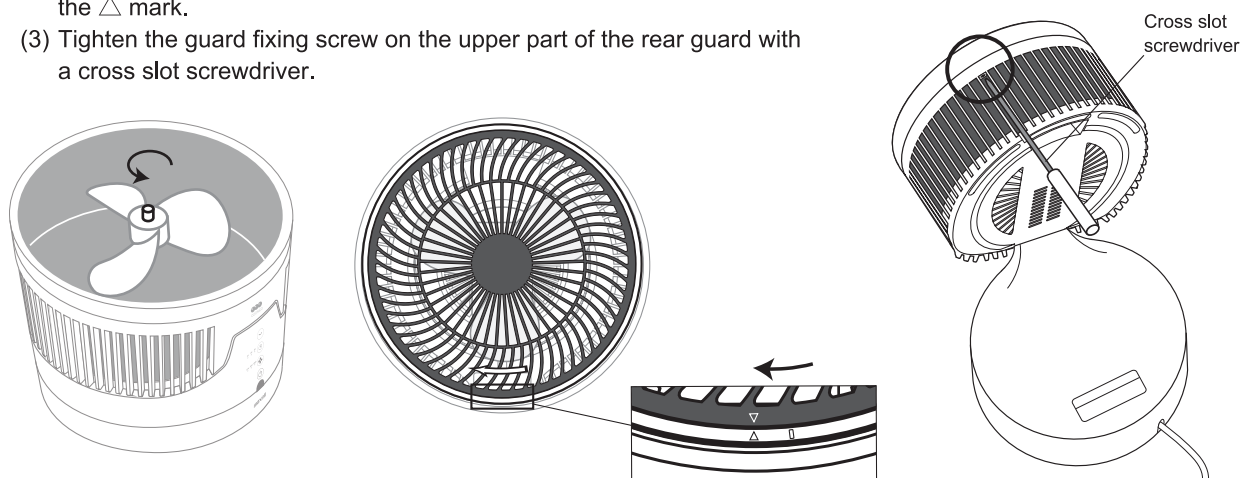

■ How to store the product

- Make sure to maintain the product before storage.
- Remove the battery from the remote controller before storage.
- Dry the product completely after maintain the product and store it in the packaging box or cover it with a plastic bag, and avoid direct sunlight and humidity when storing it.

7 Troubleshooting (If failure is suspected, check the following)

If a problem is not solved according to the following "How to remedy," contact the distributor from which you purchased your product or our "customer support center."

Phenomenon	Cause	How to remedy
The fan blades do not rotate.	The power plug is disconnected from the outlet.	Connect the power plug correctly and securely. → See Page 8.
	The power is off.	Press the power button and start operation. → See Page 8.
Abnormal sound is heard.	The spinner is loosened.	Tighten the spinner. → See Page 12.
	The guard is loosened.	Tighten the guard. → See Page 12.
Operation is stopped	The timer is set.	Adjust the timer set time. → See Page 9.
	Operation is stopped by the Auto OFF function (8 hours).	This is not an abnormal condition because this function is included in the product specifications. → See Page 9.
Operation cannot be controlled by the remote controller.	The battery is consumed.	Replace it with a new battery. → See Page 7.
	The remote controller is too far from the main body.	Use the remote controller within 3m from the main body. → See Page 7.

8 Specifications

Power supply		AC100V 50 / 60Hz
Consumed power 50/60Hz		33 / 30W
Wind speed	Low	2m/s
	Mid	3m/s
	High	4.5m/s
Swing angle	Side-to-side	Approx. 60 degrees
	Upward/downward	0 degree, 45 degrees, 90 degrees (Manual operation in three stages)
Ozone generation		Max. 10mg/h
Timer	Setting	1 to 7 hours
	Auto OFF	8 hours
Outside dimensions		Width 250mm × Depth 250mm × Height 197mm (When the swing angle of upward / downward is set to 0 degree)
Main body mass		Approx. 2.4kg
Power cord		Approx. 1.6m
Included items		Remote controller (including a battery CR2032) Instruction manual (with a warranty certificate)

*Deodorizing and anti-bacterial effectiveness is described on the following website.

http://www.maxell.jp/consumer/mxap-ard100_01.html

※Effectiveness differs depending on the ambient environment and operating time.

9 About main body labeling indications based on long-term use product safety indication system

■ Content label displayed on the main body

In order to call attention to the possibility of occurrence of hazards caused by aging deterioration, the following label required by the Electrical Appliances and Materials Safety Act is attached to the main body.

[Manufacturing year]	2018
[Design standard period of use]	4 years
 Use of the product for a period exceeding the design standard period of use may result in an accident such as ignition or injury caused by aging deterioration. * The [design standard period of use] is different from the "warranty period."	

■ What is the design standard period of use?

※It is a standard period for which the product can be used without any safety problem from the manufacturing year when taking into consideration aging deterioration based on the standard operating conditions including operating time and temperature/humidity.

※The design standard period of use is different from the free warranty period. In addition, this does not warrant accidental failure.

■ Standard operating conditions

According to Japanese Industrial Standards JIS C 9921-1.

Environmental conditions	Voltage	Single-phase AC100V	According to the product rated voltage
	Frequency	50Hz and 60Hz	
	Temperature	30°C	
	Humidity	65%	
	Installing conditions	Standard installation	According to the Instruction Manual of the device
Load conditions		Rated load (wind speed)	According to the Instruction Manual of the device
Assumed conditions	Operating time	8h/day	
	Number of times of operation	5 times/day	
	Number of operating days	110 days/year	
	Number of times of switch operation	550 times/year	
	Ratio of swinging motion	100%	

※Humidity 65% of environmental conditions refers to the testing state of JIS Z 8703.

- "Aging deterioration" means deterioration caused by long-term use or storage of a product.

Maxell, Ltd.
30-13 Motoyoyogi-Cho,
Shibuya-Ku, Tokyo 151-8527
<http://www.maxell.co.jp>