



Bluetooth®  
Wireless Earphone

# MXH-BTN350

## User manual

Thank you for purchasing this MAXELL product. Before use, make sure to read this Instruction Manual and use the product correctly and safely.

### ■ Contents of the package

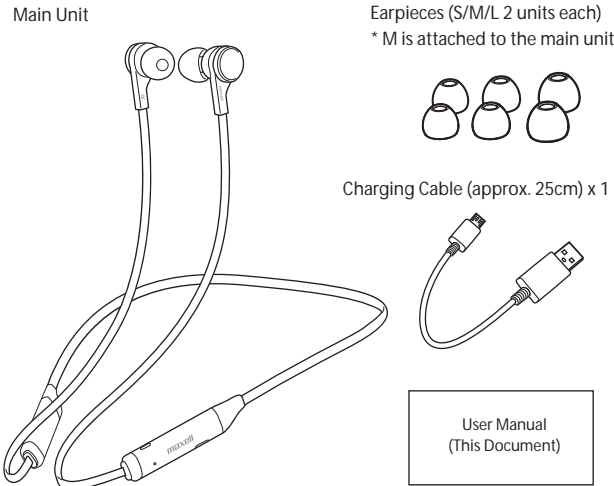

## 1 Introduction

### About the user manual

- This Instruction Manual may be subject to change without prior notice.
- In order to improve the product, external appearance or part of the specifications may be subject to change without prior notice.

### Disclaimer

- Maxell shall not be responsible for any damage caused by fires, earthquakes, action of a third party, any accidents, intended or unintended misuse or other usage under abnormal conditions.
- Maxell shall not be responsible for failure due to any damage caused by usage other than described in the instruction manual.
- This product is not being designed to be any equipment or device which could be concerned with human life such as medical device, nuclear device, astronomical device, transportation device etc., nor equipment or devices which requires high reliability. In case this product is used for the above equipment and/ or systems, Maxell do not responsible for any injuries or fire accident cause by the failure of this product.
- This product is Japanese specification. We assume no responsibility if use outside Japan.

## 2 Safety Caution

Please strictly follow

	<b>Danger</b>	If it is handled incorrectly, the user may suffer death or severe injury <sup>*1</sup> and the urgency is high.
	<b>Warning</b>	If it is handled incorrectly, it is assumed that the user may suffer death or serious injury <sup>*1</sup> .
	<b>Caution</b>	If it is handled incorrectly, it is assumed that the user may suffer minor injury <sup>*2</sup> or there is a possibility that property damage <sup>*3</sup> may occur."

- \*1: Severe injury is indicated by those that have after effects such as blindness, injury, burns (high temperature burns/low temperature burns, chemical burns), electric shock, fracture, poisoning, etc. and those requiring hospitalization or long-term regular hospital visits for treatment.
- \*2: Minor injury refers to hurt, burnt, electric shock, etc. which do not result in hospitalization or long-term follow-up consultation
- \*3: Property damage refers broad damages to houses or properties and domestic animals/ pets.

Examples of Symbol		△ stands for caution to fire, explosion, high temperature when handling the product. Details will be illustrated inside the symbol.
		⊘ stands for prohibited actions when handling the product. Details will be illustrated inside or next to the symbol or with written description next to it.
		● stands for instruction which must be followed. Details will be illustrated inside or next to the symbol or with written description next to it.

<b>Danger</b>	
<b>Take power only from the USB port</b>	
When charging, please use USB port of computer etc. or USB adapter. Using other power exceeding USB rating may result in heat generation, ignition, failure, electric shock or injury.	
<b>Do not touch leaked liquid</b>	
Please do not touch the leaked liquid. If liquid leaks from this device and gets into the eye, do not rub. Rinse with plenty of clean water immediately and consult a doctor. It may cause blindness.	

<b>Warning</b>	
<b>Do not use while driving a car, motorcycle, a bike, etc.</b>	
May cause traffic accident as hard to hear surroundings.	
<b>Do not use at locations where it will be dangerous if surrounding sounds cannot be heard</b>	
Even while walking, using it in where it will be dangerous if surrounding sounds cannot be heard (such as railway crossings, crosswalks, station platforms, roadways, construction sites, etc.) can cause unexpected serious accidents.	

<b>Do not use in locations where the use of wireless devices is prohibited</b>	
Radio waves may affect cardiac pacemakers and medical equipment. Please do not use in areas where use of wireless equipment is prohibited such as in hospitals or priority seat of trains etc.	

<b>Store properly at places out of children's reach</b>	
If the cord is swallowed or tangled around the neck, it may cause suffocation etc. In case of accident, seek medical attention immediately.	

<b>Do not place in direct sunlight or where the temperature is too high</b>	
The surface of equipment and parts may deteriorate, result in causing fire. Please take extra care in closed automobile in summer, or it is under direct sunlight or near a stove.	

<b>Do not put into fire</b>	
This may result in heat generation, ignition, breakage, leakage.	

<b>Do not put into water</b>	
This may cause fire or electric shock.	

<b>Do not repair, alter or disassemble these parts</b>	
Fire, electric shock, injury may occur.	

<b>Turn off the power in case of abnormality</b>	
If smoke or strange smell or sounds comes out, or water or foreign object gets inside, or the product is dropped, please turn off the power immediately. Furthermore, if it is being charged via USB, unplug the USB connection. Continued usage may cause heat generation, ignition, malfunction, electric shock, etc.	

<b>If the charging is not completed even after exceeding the predetermined charging time, stop charging</b>	
It may cause leakage, overheating, fire or breakage.	

<b>Caution</b>	
<b>Do not increase the volume too much</b>	
Continuously listening to loud volume can result in over stimulation of ears for an extended period of time. It may affect the hearing. Furthermore, if the volume is raised too much from the beginning, the sudden loud sounds may harm ears. Before using, please reduce the volume of the connected device.	
<b>Discontinue use when it does not fit your skin</b>	
Continued usage may cause irritation or rash. If you feel an abnormality, please discontinue use and seek medical attention.	
<b>Do not force the earphones into your ear</b>	
It may hurt your ear hole.	
<b>Charge and use within the temperature range of 5~40°C</b>	
Charging and using at temperatures outside this range may cause leakage, overheating, breakage, or malfunction.	
<b>Make sure the USB connector does not get dusty</b>	
Please remove dust and dirt regularly. Otherwise it may cause overheating or fire.	
<b>Keep away from magnetic cards</b>	
If they are placed close, Credit Cards may be easily affected by magnetic field and lose data.	

### Note on wireless use

This device uses 2.4 GHz frequency band. This frequency band is used by internal radio stations (radio stations that requires a license), specific low-power radio stations (radio stations that do not require a license) and amateur radio stations (radio stations that requires a license) for moving object identification that are used in industrial, also scientific, and medical equipment such as microwave ovens as well as factory manufacturing lines.

1. Before using this device, make sure that any internal radio station, any specific low power radio station or any amateur radio station for moving object identification are not operated nearby.
2. In the unlikely event of radio interference to an internal radio station for moving object identification from the device, immediately change the location of use or stop the emission of radio waves.
3. In addition, when any troubles arise such as radio interference to a specific low-power radio station or an amateur radio station for moving object identification from this unit happened, please contact our company's "Customer Service Center".
4. This unit is certified as a low-power data communication system based on the Radio Law. Therefore, you do not need a wireless station license to use this machine. However, it is prohibited to disassemble, remodel or erase the certification marking on the product.
5. Please do not use in areas where use of mobile phone and wireless equipment is prohibited such as in hospitals or priority seat of trains etc.



This radio equipment uses the 2.4 GHz band. The FHSS modulation method is adopted as the modulation method, and the interference distance is 10 m.

3 Name of Each Part

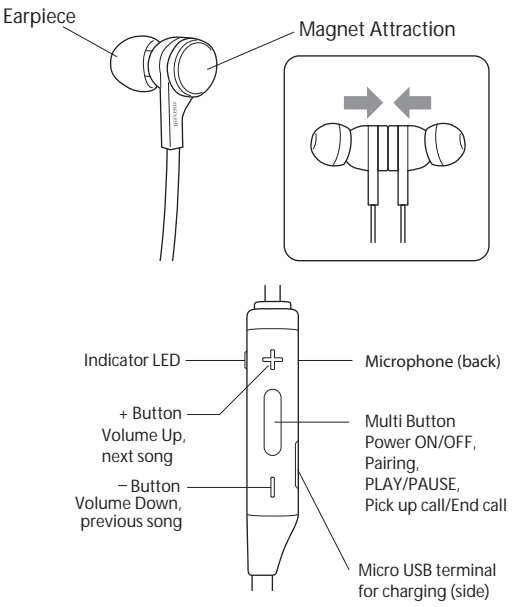

4 Preparation

<Charging>  
This product has a built-in lithium ion battery. After purchase, please charge before use.

1. Connect the supplied charging USB cable to the main unit and to the USB port of PC or USB adapter.
2. The indicator on the main unit turns red and charging begins.
3. Charging is completed when the indicator lamp turns off. (Charging time: about 3 hrs)

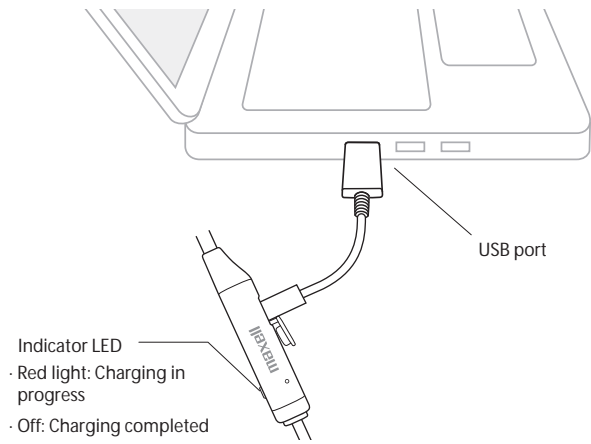

4. Remove the charging USB cable. When the remaining battery power is low, the red indicator light will flash. Please charge immediately.

- ※ Do not use any USB cable other than the supplied USB cable.
- ※ Please check the direction of the terminal carefully before inserting the charging cable. If it is inserted incorrectly, the terminal may be damaged.
- ※ Please use 5 V DC power supply based on the USB standard for USB port.
- ※ If device is not being used for an extended period of time, please charge at least once every 6 months. Charging may not be possible if it is completely discharged by itself.
- ※ The Lithium-ion battery is a consumable item. The more the battery is used, the shorter the time the battery functions per charge. If the function time per charge becomes extremely short, then the battery has reached the end of its life.
- ※ The device cannot be operated during charging.

<Choosing an earpiece>

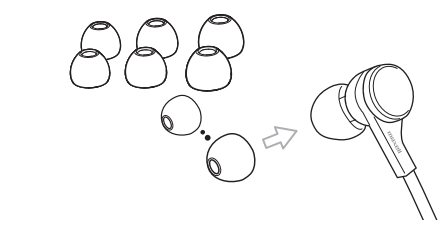

At the time of purchase, size M earpiece are attached to the main unit. If size M does not fit your ears, please replace with the size S or size L earpiece in the contents.

If the earpiece does not fit correctly, it will not be possible to seal the ear hole with the earpiece, which may cause sound leakage and no bass to be heard. Also, if you feel that the volume is low, there is a possibility of sound leakage.

5 How To Use

<Pairing and connecting>

In order to use this product, it is necessary to pair with your Bluetooth device. Once pairing is done, you can connect without pairing again.

1. Press and hold the Multi Button for about 8 seconds from the power OFF state. (The blue lamps light up in about 3 seconds and the power turns on, but please continues to press and hold the Multi Button for the full 8 seconds.)
2. When pairing mode is on, the display lamp flashes red and blue alternately.
3. Activate Bluetooth on your Bluetooth device.
  - ※For details on setting, please refer to the instruction manual of the device.
4. Select "MXH-BTN350" from the list displayed on your Bluetooth device.
5. When pairing is completed, the blue indicator light flashes.

<Connection after the second time onward>

1. Press and hold down the Multi Button for about 3 seconds from the power OFF state.
2. When the power turns ON, the blue indicator lamp flashes, then, red light flashes slowly
3. Activate Bluetooth on your Bluetooth device.
4. The earphone will connect automatically\*1. After connect, blue light will flash slowly.

\*1: If it is not connect automatically, select "MXH-BTN350" from the list displayed on your Bluetooth device.

Caution

- The pairing mode ends in about 2 minutes, and if it is not paired during that time, it would turn off automatically.
- Password\*2 input may be requested by your Bluetooth device. In that case, you can pair it by entering "0000".
- This product can simultaneously store up to 8 paired Bluetooth devices. When more than 8 pairings are attempted, the information of the 1st stored Bluetooth device is erased and is replaced by the newly paired device. If you want to use a Bluetooth device whose information has been erased, please pair it again.

\*2: Password may be called passcode, passkey, PIN code, etc.

<Wearing headphones>



<How to operate>

■ Common function

Function	Operation	Display lamp
Power On	Press and hold the Multi Button for about 3 seconds	After blue light is illuminated red light flashes slowly
Power Off	Press and hold the Multi Button for about 4 seconds	After red light is illuminated, it turns off
Standby mode	Turn on the power to enter standby mode	Red light flashes slowly
Pairing mode	Press and hold the Multi Button for about 8 seconds while the power is off	Blue light and Red light flash alternatively
Pairing complete	Pair this product from your Bluetooth device. Please refer to <Pairing and connecting>	Blue light flashes slowly
Connect	After pairing is completed, automatically connects if Bluetooth of your Bluetooth device is enabled*3	Blue light flashes slowly
Disconnect	Disconnect the product from your device (or disable Bluetooth)	Red light flashes slowly

\*3: If it does not connect automatically, please select "MXH-BTN350" from the list displayed on your Bluetooth device.

Caution

- When the Bluetooth connection is not made and about 2 minutes elapses, the power turns off automatically.

■ Music Playback

Function	Operation
PLAY / PAUSE	Press Multi Button to change play and pause
Volume UP	Press the + Button
Volume DOWN	Press the – Button
Next song (proceed to the next song)	Press and hold down the + Button for about 1.5 second
Previous song (return to the beginning of the currently playing song*4)	Press and hold down the – Button for about 1.5 second

\*4: If the button is pressed at the beginning of the song, it will proceed the previous song.

Caution

- Depending on your Bluetooth device, the operation may differ or may not be usable.

■ Hands free call

Function	Operation
Receiving a call	Press the Multi Button when receiving a call
Ending a call	Press the Multi Button during a call The other party disconnects the call
Volume UP	Press the + Button
Volume DOWN	Press the – Button

Caution

- Depending on your Bluetooth device, the operation may differ or may not be usable.

■ Multipoint function

If 2 mobile phones are in standby mode at the same time, you can receive phone calls from either one of the two mobile phones with this product.

<How to set>

1. Pair this product with the first mobile phone. Please refer to 5 <Pairing and connecting> for how to operate.
2. Turn off the Bluetooth function of the first mobile phone.
3. Pair this product with the second mobile phone.
4. Turn on the Bluetooth function of the first mobile phone. Now both mobile phones will be on standby mode at the same time.

<How to use>

To receive a call: Press the Multi Button when receiving a call.

To end a call: Press the Multi Button during a call.

Caution

Depending on your Bluetooth device, the operation may differ or may not be usable.

6 Troubleshooting

The power does not turn on	<ul style="list-style-type: none"> <li>· Press and hold down the Multi Button for about 3 seconds.</li> <li>· Please charge the device.</li> </ul>
No sound	<ul style="list-style-type: none"> <li>· Please pair and connect Bluetooth.</li> <li>· Make sure that the Bluetooth device supports A2DP.</li> <li>· Check if the Bluetooth device is playing.</li> <li>· Please increase the volume of the Bluetooth device slowly.</li> </ul>
Sound is distorted or interrupted	<ul style="list-style-type: none"> <li>· Please reduce the volume of the Bluetooth device and this unit.</li> <li>· Please turn off the functions such as bass boost of Bluetooth device.</li> <li>· Remove any obstacles between the Bluetooth device and this unit.</li> <li>· Keep the Bluetooth device close to this unit.</li> <li>· Please keep away from radio equipment or microwave ovens.</li> </ul>
Cannot hear the voice on the phone	<ul style="list-style-type: none"> <li>· Please press the Multi Button to receive the call.</li> <li>· Make sure that the Bluetooth device supports HFP or HSP.</li> </ul>
Unable to charge	<ul style="list-style-type: none"> <li>· Please insert the charging cable completely.</li> <li>· Please charge within the charging temperature range (5°C ~ 40°C)</li> </ul>

7 Specification

Headphone specification	Driver Type	Sealed dynamic type
	Used unit	Diameter 9mm
	Audio frequency response	20~20,000Hz
	Power supply	Built-in rechargeable lithium ion battery
	Duration	Continuous playback: approx. 10 hours, Continuous standby: approx. 200 hours.
	Charging time	Approx. 3 hours
	Weight	Approx. 20g (including controller and cord)
	Accessories	Earpieces (S/M/L 2 units each) ※ M size are attached to the main units. Charging cable (USB A-Micro B approx. 25cm) x1, instruction manual
Wireless specification	Communication method	Bluetooth Ver.5.0
	Communication distance	approx. 10m
	Supported profile	A2DP, AVRCP, HFP, HSP
	Supported codecs	SBC
	Supported content protection	SCMS-T
	Multipoint	Max. up to 2 units
	Multi-pairing	Max. up to 8 units

※Specifications and appearances are subject to change without prior notice for improvement.

※This device has a lithium ion battery built in. Usage time and battery charging time are based on our test results. It depends on the usage environment.

The Bluetooth® word mark and logos are registered trademarks owned by Bluetooth SIG, Inc. and any use of such marks by Maxell Asia, Ltd. is under license.

The names, logos, and service marks are registered trademarks and trade names of maxell or their respective owners.

**Maxell, Ltd.**  
 30-13 Motoyoyogi-Cho, Shibuya-Ku, Tokyo 151-8527  
<http://www.maxell.co.jp>